

# PHILIPS

FB 692 - FB 698 Speakers

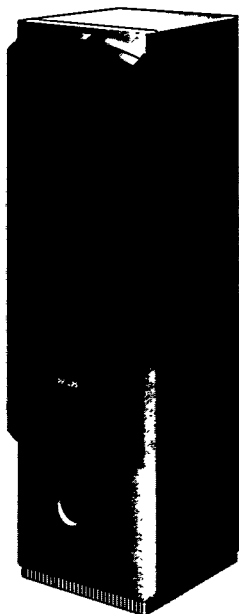

Instructions for use  
Mode d'emploi  
Instrucciones de manejo  
Bedienungsanleitung  
Gebruiksaanwijzing  
Istruzioni per l'uso  
Manual de utilização  
Brugsanvisning  
Bruksanvisning  
Käyttöohje  
Οδηγίες χρήσεως  
使用説明書

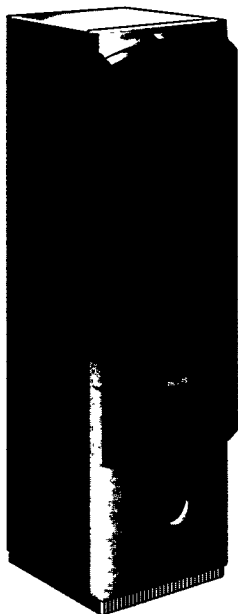

# PHILIPS



**(AUS) Australia**

Garantíe ..... page 28

**(NZ) New Zealand**

Garantíe ..... page 28

**(BR) Brasil**

Garantía ..... página 29

**(MEX) México**

Garantía ..... página 29



Lea cuidadosamente su instructivo de manejo.

**(I) Italia**

**DICHIARAZIONE DI CONFORMITA'**

Si dichiara che l'apparecchio FB 692/698 Philips risponde alle prescrizioni dell'art. 2 comma 1 del D. M. 28 Agosto 1995 n. 548

Fatto a Eindhoven, il 12/03/1996

Philips Sound & Vision  
Philips, Glaslaan 2, SFF 10  
5616 JB Eindhoven, The Netherlands

<b>English</b> ..... 4	English
<b>Français</b> ..... 6	Français
<b>Español</b> ..... 8	Español
<b>Deutsch</b> ..... 10	Deutsch
<b>Nederlands</b> ..... 12	Nederlands
<b>Italiano</b> ..... 14	italiano
<b>Português</b> ..... 16	Português
<b>Dansk</b> ..... 18	Dansk
<b>Svenska</b> ..... 20	Svenska
<b>Suomi</b> ..... 22	Suomi
<b>Ελληνικά</b> ..... 24	Ελληνικά
<b>中文</b> ..... 26	中文

# INSTRUCTIONS FOR USE

English

## INTRODUCTION

We would like to thank you for purchasing these quality speakers from the Philips 600 range. These speakers have been developed to produce superb sound for many years of listening pleasure.

Please read this manual carefully before connecting your speakers. You will find a number of useful tips for getting the best out of these high-quality speakers.

## POWER HANDLING

Each amplifier or receiver used at high power over a long period of time can produce distortions which may seriously damage your speakers.

Your ears will warn you, since the speakers will indicate overloading by giving severe distortion.

If this happens, reduce the volume and tone controls to a level where the sound is acceptable again.

When using microphones, avoid microphone feedback which occurs when microphones may pick up sound from the speakers, resulting in a dangerous howling sound. Keep the microphones away from the speakers or reduce the volume.

### Remember

Speakers are most often damaged when they are overdriven by under-powered amplifiers.

## TWEETER PROTECTION

These speakers contain a special protection circuit to prevent overloading of the tweeter (the high-tone speaker).

This protection circuit indicates overloading in two steps:

- 1. Yellow:** If the yellow indication lights up, the tweeter is playing at its maximum level.
- 2. Red:** If the red indication lights up, the protection circuit has switched off the tweeter. By reducing the volume and tone adjustments on your amplifier/receiver to a comfortable level, the protection circuit will automatically switch on the tweeter again and the red indication extinguishes.

## RECYCLING

- All redundant packaging material has been omitted. The packaging is easy separable into three mono-materials:
  - cardboard (box)
  - expandable polystyrene (buffer)
  - polyethylene (bags, protective foam sheet)
- Your set consists of materials which can be recycled if disassembled by a specialized company.
- Please observe the local regulations regarding the disposal of packing materials and old equipment.

*The type plate can be found on the bottom or the back of the speaker*

*This product complies with the radio interference requirements of the European Community.*

## CONNECTING YOUR LOUDSPEAKERS

**Notel** Check that your amplifier/receiver is switched off.

### Connectors on the speakers

- At the rear of the speakers you will find two screw connectors, a red one marked ⊕ and a black one marked ⊖.
- Preferably use special speaker cable having a section area of at least 0.75 mm<sup>2</sup>.
- Strip off the insulation from the end of each of the two wires; approx. 7 mm.
- One of both speaker wires is usually marked with a colour or a sleeve so that you can distinguish between them.
- In order to prevent phase problems, make a habit of connecting the marked (coloured) wire to the red ⊕ speaker terminal and the unmarked wire to the black ⊖ speaker terminal.

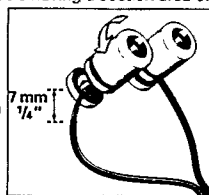

### Connectors on the amplifier/receiver

The speaker connections on the amplifier or receiver may be either click-fit or screw connectors.

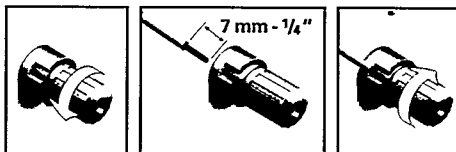
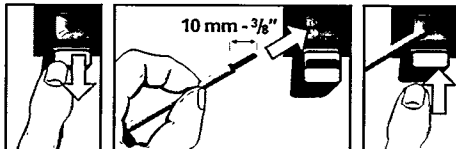

- At the rear of the amplifier/receiver you will find a red or ⊕ terminal and a black or ⊖ terminal for each speaker.
- Connect the marked or sleeved speaker wire to the red or ⊕ terminal, and the unmarked wire to the black or ⊖ terminal of the amplifier/receiver.

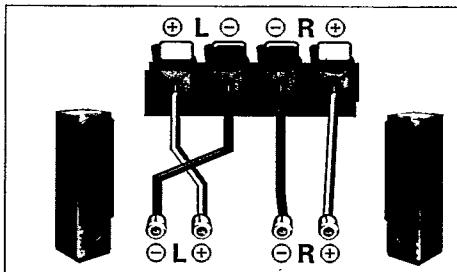

# INSTRUCTIONS FOR USE

English

## GENERAL HINTS FOR POSITIONING

- Avoid positioning the speakers in a corner or on the floor, as this will boost the bass tones too much
- Placing the speakers behind curtains, furniture etc will reduce the treble response, thus reducing the stereo effect considerably. The listener should still be able to 'see' the speakers
- Each room has different acoustic characteristics and the positioning possibilities are often limited. You can find the best position for your speakers by experimenting. In general, the speakers should be arranged as symmetrically as possible in the room
- The speakers should be arranged so that, viewed from the listener's position, the speaker connected to the 'Left' terminals of the amplifier/receiver is on the left and the speaker connected to the 'Right' terminals is on the right in front of the listener in the room. This can be checked with the balance control on the amplifier/receiver
- The best stereo effect is obtained when the 2 speakers and the listener build an equilateral triangle

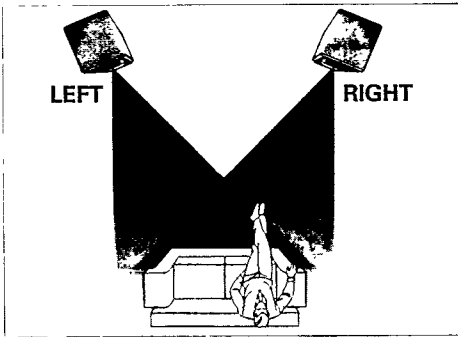

## MAINTENANCE

- A chamois leather slightly moistened with water is sufficient for cleaning the speaker cabinet
- Do not use cleaning agents containing alcohol, spirits, ammonia or abrasives
- Do not leave the speakers for any length of time in direct sunlight or other places where high temperatures can occur, such as in the vicinity of heating apparatus.
- Do not expose the speakers to humidity or rain

## TROUBLESHOOTING

If a fault occurs, first check the points listed below before taking the speakers for repair

If you are unable to remedy a problem by following these hints, consult your dealer or service centre

### WARNING

Under no circumstances you should try to repair the speaker yourself, as this would invalidate the guarantee

## PROBLEM

- POSSIBLE CAUSE
- REMEDY

### No sound

- *VOLUME* is not turned up
- Turn up the *VOLUME*
- *SPEAKERS A/B* switches on the amplifier/receiver are in position off
- Press the relevant *SPEAKERS A* or *B* switch
- *Headphones* are connected
- Disconnect headphones
- *Speakers* are not (or wrongly) connected
- Connect the speakers securely

### No sound on left or right side

- *BALANCE* control on the amplifier/receiver is not in the middle position
- Set the *BALANCE* control to the middle position
- *One speaker* is wrongly connected or the speaker cable damaged
- Connect the speaker properly or replace the cable

### Reversed left and right sound

- *Speakers* are wrongly connected
- Connect speakers properly, **L** to left, **R** to right, check with *BALANCE* control

### Poor bass sound

- *Speakers* are not in phase
- Connect speakers properly, ⊕ to ⊕ -pole (red marked or sleeved cable), ⊖ to ⊖ -pole (unmarked cable)

## TECHNICAL DATA

Subject to change without notice

System	FB 692	FB 698
	2-way Bass	3-way Bass
	Reflex	Reflex
<b>Power handling capacity:</b>		
- continuous	90 Watts	120 Watts
- peak (max 10 minutes)	180 Watts	240 Watts
Impedance	6 Ohms	6 Ohms
Sensitivity (2.83 V/1 metre)	87 dB	89 dB
Frequency response	40-20,000 Hz	38-20,000 Hz
Crossover frequency	4500 Hz	4000 Hz
Material cabinet	16 mm E1	16 mm E1
Material baffle	High Impact PS	High Impact PS
Volume internal/external	24/42 litres	37/53 litres
Weight	10 kg	12 kg
<b>Dimensions</b>		
- Height	790 mm	860 mm
- Width	215 mm	230 mm
- Depth	250 mm	250 mm
<b>Loudspeakers:</b>		
- Tweeter	25 mm Dome	25 mm Dome
- Woofer	7"	2 x 7"
<b>Screw connectors</b>	gold-plated	gold-plated

**GUARANTEE FOR AUSTRALIA**

The benefits given to the purchaser by this warranty are in addition to all other rights and remedies, which, under the Trade Practices Act or other Commonwealth or State law, the purchaser or owner has in respect of the product.

The Philips product carries the following warranties:

- C-series HiFi-systems 12 months.
- Compact Disc Players: 12 months.
- Home Audio Systems: 6 months.
- Clock radios, portable radios, cassette recorders, cassette players and radio recorders: 90 days.

Any defect in materials or workmanship occurring within the specified period from the date of delivery, will be rectified free of charge by the retailer from whom this product was purchased.

**Note:** Please retain your purchase docket to assist prompt service.

**Conditions of this warranty**

1. All claims for warranty service must be made to the retailer from whom this product was purchased. All transport charges incurred in connection with warranty service or replacement will be paid by the purchaser.
2. These warranties do not cover batteries and extend only to defects in materials or workmanship occurring under normal use of the product where operated in accordance with our instructions.

**Philips**

**Consumer Products Division  
Technology Park  
Figtree Drive, Australia Centre  
Homebush 2140  
New South Wales**

**GUARANTEE FOR NEW ZEALAND**

Thank-you for purchasing this quality Philips product. Philips New Zealand Ltd guarantees this product against defective components and faulty workmanship for a period of 12 months. Any defect in materials or workmanship occurring within 12 months from the date of purchase subject to the following conditions will be rectified free of charge by the retailer from whom this product was purchased.

**Conditions**

1. The product must have been purchased in New Zealand. As proof of purchase, retain the original sales docket indicating the date of purchase.
2. The guarantee applies only to faults caused by defective components, or faulty workmanship on the part of the manufacturer.
3. The guarantee does not cover failures caused by misuse, neglect, normal wear and tear, accidental breakage, use on the incorrect voltage, use contrary to operating instructions, or unauthorised modification to the product or repair by an unauthorised technician.
4. Reasonable evidence (in the form of a sales docket) must be supplied to indicate that the product was purchased no more than 12 months prior to the date of your claim.
5. In the event of a failure, Philips shall be under no liability for any injury, or any loss or damage caused to property or products other than the product under guarantee.

This guarantee does not prejudice your rights under common law and statute, and is in addition to the normal responsibilities of the retailer and Philips.

**How to claim**

Should your Philips product fail within the guarantee period, please return it to the retailer from whom it was purchased. In most cases the retailer will be able to satisfactorily repair or replace the product.

However, should the retailer not be able to conclude the matter satisfactorily, or if you have other difficulties claiming under this guarantee, please contact.

**The Guarantee Controller  
Philips New Zealand Ltd.**

✉ P.O. Box 41.021

Auckland

☎ (09) 84 94 160

fax ☎ (09) 84 97 858







English	English .....	4
Français	Français .....	6
Español	Español .....	8
Deutsch	Deutsch .....	10
Nederlands	Nederlands .....	12
Italiano	Italiano .....	14
Dansk	Português .....	16
Nederlands	Dansk .....	18
Svenska	Svenska .....	20
Suomi	Suomi .....	22
Ελληνικά	Ελληνικά .....	24
中文	中文 .....	26

